



The 1/8" flow PMC coupling covers a wide variety of general-purpose applications. Featuring the CPC thumb latch, the PMC is easier to use than ball-and-sleeve designs. One-hand connection/disconnection and integral terminations make the PMC the choice for ease of use and manufacture.

This coupling is NuSeal® compatible (see page 27 for details).

FEATURES

- Hose barb shroud
- Integral terminations
- Compatible
- Clicks when connected

BENEFITS

- Extra protection for the 1/16" hose barb
- Fewer leak points, shorter assemblies, faster installations
- Mates with PMC12 and MC Series couplings (see pages 30 and 34)
- Assurance of a reliable connection

PMC Air Flow, 100 psig Inlet Pressure

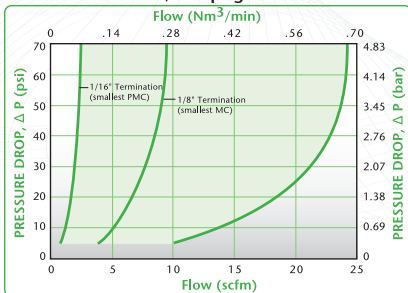

PMC Water Flow

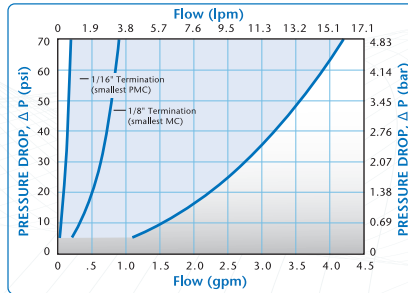

PMC Pressure Range

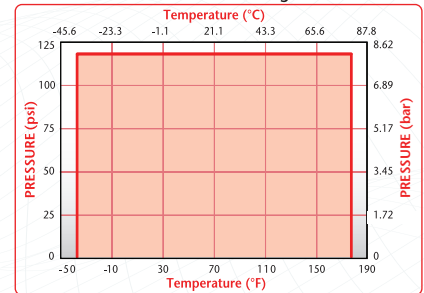

These graphs are intended to give you a general idea of the performance capabilities of each product line. The shaded area of each graph represents the operating range of the product family, i.e., upper and lower values are shown. Therefore, depending on the exact coupling configurations selected, you can reasonably expect values to fall within the shaded area.

Also available in NSF listed versions. Please visit our website for part number information.

Specifications

PRESSURE:

Vacuum to 120 psi, 8.3 bar

TEMPERATURE:

-40°F to 180°F (-40°C to 82°C)

MATERIALS:

Main components and valves: Acetal

Thumb latch: Stainless steel

Valve spring: 316 stainless steel

External springs and pin: Stainless steel

O-rings: Buna-N

COLOR:

Natural white, others available

TUBING SIZES:

1/16" to 1/4" ID, 1.6mm to 6.4mm ID

WARNING: Pressure, temperature, chemicals, and operating environment can affect the performance of couplings. It is the customer's responsibility to test the suitability of CPC products in their own application conditions.

NU-SEAL® QUICK DISCONNECT COUPLING

Nu-Seal® Specifications

PRESSURE:

Vacuum to 20 psi, 1.4 bar

MATERIALS:

Main components:

Low density polyethylene

COLOR:

Translucent

TUBING SIZE:

1/8" ID, 3.2mm ID

Nu-Seal® quick disconnect coupling inserts feature a patented integral seal and are USP Class VI compliant. These economic inserts are ideal for applications that require limited connect/disconnect cycles.

FEATURES

Patented integral seal

Low density polyethylene

Chemically resistant

Compatible

BENEFITS

Economical, allows for disposability and provides leak-free connections

Sterilizable by EtO, E-beam & gamma

Works in many critical USP Class VI material applications

Mates with MC, PMC, PMC12 couplings



TERMINATION
IN-LINE
HOSE BARB

TUBING SIZE
1/8" ID

METRIC EQ.
3.2 mm ID

PART NO.
DSM2202

HEIGHT
.50

LENGTH
.98

Liquid Flow Rate Information for Couplings

The chart below shows the flow rate for CPC couplings. Each coupling was tested with water at 70°F (21°C). To determine flow rates for specific coupling configurations use the formula at the right.

$$Q = C_v \sqrt{\frac{\Delta P}{S}}$$

- Q = Flow rate in gallons per minute
- C_v = Average coefficient across various flow rates (see chart)
- ΔP = Pressure drop across coupling (psi)
- S = Specific gravity of liquid

C_v VALUES FOR 1/8" FLOW PMC COUPLINGS

BODIES	INSERTS																	
	PMC 2004	PMCD 2004	PMC 2006	PMCD 2006	PMC 2202	PMCD 2202	PMC 2204	PMCD 2204	PMC 2402	PMCD 2402	PMC 2404	PMCD 2304	PMC 2104	PMCD 2304	PMC 2203	PMCD 2203	PMC 2201	PMCD 2201
PMC1002	.40	.18	.50	.19	.25	.16	.50	.19	.50	.20	.51	.50	.38	.24	.30	.17	.03	.03
PMCD1002	.27	.18	.31	.18	.24	.16	.28	.20	.26	.20	.29	.26	.27	.24	.25	.17	.03	.03
PMC1004	.40	.21	.50	.24	.26	.18	.50	.24	.50	.20	.51	.50	.38	.26	.30	.19	.03	.03
PMCD1004	.29	.19	.32	.23	.25	.17	.30	.23	.27	.21	.28	.28	.29	.24	.25	.18	.03	.03
PMC1204	.40	.18	.50	.18	.25	.16	.40	.18	.40	.16	.36	.40	.38	.21	.30	.17	.03	.03
PMCD1204	.21	.17	.22	.17	.20	.16	.22	.17	.21	.17	.20	.22	.21	.18	.21	.16	.03	.03
PMC1602	.23	.15	.28	.18	.19	.14	.27	.15	.27	.15	.28	.27	.23	.16	.20	.14	.03	.03
PMCD1602	.19	.15	.19	.15	.17	.14	.19	.15	.18	.15	.18	.19	.19	.15	.18	.14	.03	.03
PMC1604	.33	.23	.44	.24	.24	.18	.44	.23	.44	.20	.38	.44	.33	.26	.26	.19	.03	.03
PMCD1604	.23	.17	.26	.21	.22	.16	.26	.21	.26	.19	.25	.26	.23	.24	.22	.16	.03	.03
PMC1703	.25	.20	.30	.20	.20	.17	.30	.20	.30	.19	.28	.30	.25	.18	.21	.17	.03	.03
PMCD1703	.20	.17	.20	.17	.19	.15	.21	.17	.19	.17	.20	.20	.20	.16	.19	.16	.03	.03
PMC1701	.03	.03	.03	.03	.03	.03	.03	.03	.03	.03	.03	.03	.03	.03	.03	.03	.03	.02
PMCD1701	.03	.03	.03	.03	.03	.03	.03	.03	.03	.03	.03	.03	.03	.03	.03	.03	.02	.02

PMC DIMENSIONS

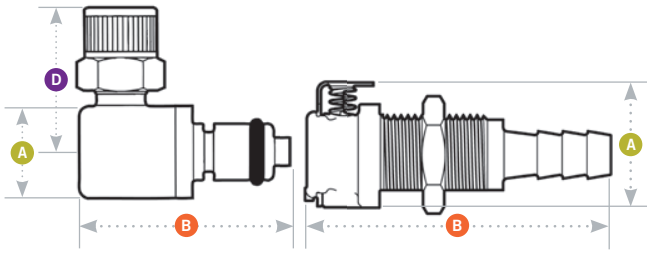

- A = Height/Diameter
- B = Total Length
- D = Elbow Radial Length

Panel Dimensions

	PANEL OPENING	PANEL THICKNESS MAX. - MIN.	PANEL NUT HEX	PANEL NUT THREAD
COUPLING BODIES	see drawing	.50 - .05	5/8	1/2-24UNS
COUPLING INSERTS	1/2	.30 - .05	5/8	1/2-24UNS

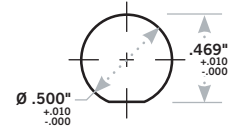

Greenlee® punch number 60077

Coupling Bodies • ACETAL

TERMINATION	TUBING/THREAD SIZE	METRIC EQ.	STRAIGHT THRU	SHUTOFF	A	B
IN-LINE PIPE THREAD	1/8" NPT		PMC1002	PMCD1002	.79	1.00
	1/8" BSPT		PMC1002BSPT	PMCD1002BSPT	.79	1.00
	1/4" NPT		PMC1004	PMCD1004	.79	1.10
	1/4" BSPT		PMC1004BSPT	PMCD1004BSPT	.79	1.10
PANEL MOUNT FERRULELESS POLYTUBE FITTING, PTF†	5/32" OD, .10" ID	4.0mm OD, 2.0mm ID	PMC12M42	PMCD12M42	.77	1.65
	4.0mm OD, 2.5mm ID	4.0mm OD, 2.5mm ID	PMC12025	PMCD12025	.77	1.70
	1/4" OD, .17" ID	6.4mm OD, 4.3mm ID	PMC1204	PMCD1204	.77	1.72
PANEL MOUNT HOSE BARB	1/16" ID	1.6mm ID	PMC1601	PMCD1601	.77	1.40
	1/8" ID	3.2mm ID	PMC1602	PMCD1602	.77	1.65
	3/16" ID	4.8mm ID	PMC1603	PMCD1603	.77	1.85
	1/4" ID	6.4mm ID	PMC1604	PMCD1604	.77	1.85
PANEL MOUNT FEMALE THREAD	10-32 UNF		PMC181032	PMCD181032	.77	1.25
IN-LINE FERRULELESS POLYTUBE FITTING, PTF†	5/32" OD, .10" ID	4.0mm OD, 2.0mm ID	PMC13M42	PMCD13M42	.81	1.65
	4.0mm OD, 2.5mm ID	4.0mm OD, 2.5mm ID	PMC13025	PMCD13025	.81	1.65
	5.0mm OD, 3.0mm ID	5.0mm OD, 3.0mm ID	PMC13M5	PMCD13M5	.81	1.72
	1/4" OD, .17" ID	6.4mm OD, 4.3mm ID	PMC1304	PMCD1304	.81	1.75
IN-LINE HOSE BARB	1/16" ID	1.6mm ID	PMC1701	PMCD1701	.81	1.41
	1/8" ID	3.2mm ID	PMC1702	PMCD1702	.81	1.45/1.65
	3/16" ID	4.8mm ID	PMC1703	PMCD1703	.81	1.65/1.85
	1/4" ID	6.4mm ID	PMC1704	PMCD1704	.81	1.65/1.85
IN-LINE FEMALE THREAD	10-32 UNF		PMC191032	PMCD191032	.81	1.25

All measurements are in inches (millimeters) unless otherwise noted. Tubing must meet stated inside and outside diameters.
 †NOTE: CPC's Ferruleless PTF (polytube fitting) terminations do not require ferrules to achieve a secure connection and are therefore easier to use and reuse. PTF fittings are designed for semi-rigid tubing, i.e., polyethylene, nylon, polyurethane, etc.

Coupling Inserts • ACETAL



**TERMINATION
IN-LINE
PIPE THREAD**

TUBING/THREAD SIZE	METRIC EQ.	STRAIGHT THRU	SHUTOFF	A	B	D
1/8" NPT		PMC2402	PMCD2402	.58	1.03/1.45	
1/8" BSPT		PMC2402BSPT	PMCD2402BSPT	.58	1.03/1.44	
1/4" NPT		PMC2404	PMCD2404	.65	1.13/1.42	
1/4" BSPT		PMC2404BSPT	PMCD2404BSPT	.65	1.13/1.42	



**PANEL MOUNT
FERRULELESS
POLYTUBE FITTING,
PTF†
(non-valved shown)**

1/4" OD, .17" ID	6.4mm OD, 4.3mm ID	PMC4004	PMCD4004	.72	1.70/1.82	
------------------	--------------------	---------	----------	-----	-----------	--



**PANEL MOUNT
HOSE BARB**

1/16" ID	1.6mm ID	PMC4201	PMCD4201	.72	1.38/1.50	
1/8" ID	3.2mm ID	PMC4202	PMCD4202	.72	1.63/1.75	
3/16" ID	4.8mm ID	PMC4203	PMCD4203	.72	1.83/1.95	
1/4" ID	6.4mm ID	PMC4204	PMCD4204	.72	1.83/1.95	



**IN-LINE
FERRULELESS
POLYTUBE FITTING,
PTF†**

	4.0mm OD, 2.0mm ID	PMC20M42	PMCD20M42	.58	1.08/1.60	
5/32" OD, .10" ID	4.0mm OD, 2.5mm ID	PMC20025	PMCD20025	.58	1.13/1.65	
1/4" OD, .17" ID	6.4mm OD, 4.3mm ID	PMC2004	PMCD2004	.58	1.15/1.57	
3/8" OD, .25" ID	9.5mm OD, 6.4mm ID	PMC2006	PMCD2006	.65	1.40/1.52	



**IN-LINE
HOSE BARB
(non-valved shown)**

1/16" ID	1.6mm ID	PMC2201	PMCD2201	.50	.80/1.47	
1/8" ID	3.2mm ID	PMC2202	PMCD2202	.50	1.00/1.67	
3/16" ID	4.8mm ID	PMC2203	PMCD2203	.50	1.20/1.88	
1/4" ID	6.4mm ID	PMC2204	PMCD2204	.50	1.22/1.70	



**IN-LINE
FEMALE THREAD**

10-32 UNF		PMC281032	PMCD281032	.58	.63/1.31	
-----------	--	-----------	------------	-----	----------	--



**ELBOW
FERRULELESS
POLYTUBE FITTING,
PTF†**

5/32" OD, .10" ID	4.0mm OD, 2.5mm ID	PMC21025		.50	1.17	.75
1/4" OD, .17" ID	6.4mm OD, 4.3mm ID	PMC2104	PMCD2104	.50	1.17/1.21	.77



**ELBOW
HOSE BARB
(non-valved shown)**

1/8" ID	3.2mm ID	PMC2302	PMCD2302	.50	.85/1.21	.75/1.69
1/4" ID	6.4mm ID	PMC2304	PMCD2304	.50	1.00/1.21	.95/1.90

All measurements are in inches (millimeters) unless otherwise noted. Tubing must meet stated inside and outside diameters. Couplings are pictured with valves unless otherwise noted. †NOTE: CPC's Ferruleless PTF (polytube fitting) terminations do not require ferrules to achieve a secure connection and are therefore easier to use and reuse. PTF fittings are designed for semi-rigid tubing, i.e., polyethylene, nylon, polyurethane, etc.

LIONOIL

ANTWERP LION OIL WORKS N.V.

Vlaamsekaai 2-5 B-2000 Antwerpen
T.: +32 (0)3 237 00 45 F.: +32 (0)3 216 21 92
info@lionoil.be www.lionoil.be

Smart fluid handling to take you forward, faster. 29