



CPC's MC Series chrome-plated brass couplings are built tough and made to last in the most demanding applications. Ideal for use with higher temperatures or pressures, MC Series couplings feature one-hand operation for swift and easy connects and disconnects. These couplings offer the flexibility of multiple configurations and terminations and mate with both PMC acetal and PMC12 polypropylene couplings.

### FEATURES

Brass material

High temperature capability

CPC thumb latch

Compatible

### BENEFITS

Durable and able to withstand higher pressure and temperature

Versions rated to 400°F (204°C)

One-hand connection and disconnection

MC mates with PMC and PMC12 Series couplings

### Specifications

#### PRESSURE:

Vacuum to 250 psi, 17.3 bar

#### TEMPERATURE:

-40°F to 180°F (-40°C to 82°C)  
(High temperature versions available with ratings to 400°F)

#### MATERIALS:

**Main components:**  
Chrome-plated brass

**Thumb latch:** Stainless steel

**Valves:** Acetal

**Valve spring:** 316 stainless steel

**External springs and pin:** Stainless steel

**O-rings:** Buna-N

#### FINISH:

Chrome

#### TUBING SIZES:

1/8" to 1/4" ID, 3.2mm to 6.4mm ID

**WARNING:** Pressure, temperature, chemicals, and operating environment can affect the performance of couplings. It is the customer's responsibility to test the suitability of CPC products in their own application conditions. Use the graph to the right as a guide.

**Note:**  
High temperature versions available with ratings to 400 F. Call customer service for more information.

Also available in NSF listed versions, please visit our website for part number information.



These graphs are intended to give you a general idea of the performance capabilities of each product line. The shaded area of each graph represents the operating range of the product family, i.e., upper and lower values are shown. Therefore, depending on the exact coupling configurations selected, you can reasonably expect values to fall within the shaded area.

MC Air Flow, 100 psig Inlet Pressure

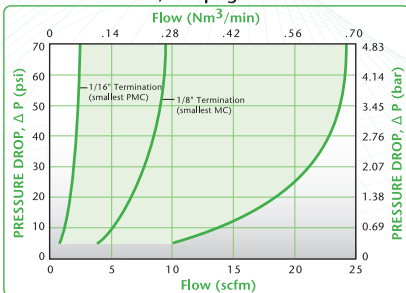

MC Water Flow

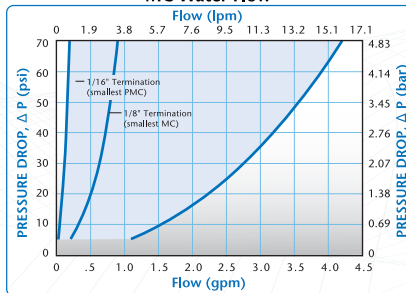

## DID YOU KNOW?



### CPC OFFERS KEYED, COLOR-CODED COUPLING OPTIONS:

CPC's MC Series couplings are also available in keyed, color-coded versions? Specifically designed for applications requiring foolproof connections and non-interchangeable lines, these couplings are a durable and attractive solution for high-volume applications. Contact CPC for more information.

## Liquid Flow Rate Information for Couplings

The chart below shows the flow rate for CPC couplings. Each coupling was tested with water at 70°F (21°C). To determine flow rates for specific coupling configurations use the formula at the right.

$$Q = C_v \sqrt{\frac{\Delta P}{S}}$$

**Q** = Flow rate in gallons per minute  
**C<sub>v</sub>** = Average coefficient across various flow rates (see chart)  
**ΔP** = Pressure drop across coupling (psi)  
**S** = Specific gravity of liquid

### C<sub>v</sub> VALUES FOR 1/8" FLOW MC COUPLINGS

BODIES	INSERTS																	
	MC 2004	MCD 2004	MC 2006	MCD 2006	MC 2202	MCD 2202	MC 2204	MCD 2204	MC 2402	MCD 2402	MC 2404	MCD 2304	MC 2602	MCD 2304	MC 2104	MCD 2304	MC 2203	MCD 2203
MC1002	.40	.18	.50	.19	.25	.16	.50	.19	.50	.20	.51	.19	.50	.50	.38	.24	.30	.17
MCD1002	.27	.18	.31	.18	.24	.16	.28	.20	.26	.20	.29	.18	.26	.26	.27	.24	.25	.17
MC1004	.40	.21	.50	.24	.26	.18	.50	.24	.50	.20	.51	.24	.50	.50	.38	.26	.30	.19
MCD1004	.29	.19	.32	.23	.25	.17	.30	.23	.27	.21	.28	.23	.27	.28	.29	.24	.25	.183
MC1204	.40	.18	.50	.18	.25	.16	.40	.18	.40	.16	.36	.18	.40	.40	.38	.21	.30	.173
MCD1204	.21	.17	.22	.17	.20	.16	.22	.17	.21	.17	.20	.17	.21	.22	.21	.18	.21	.16
MC1602	.23	.15	.28	.18	.19	.14	.27	.15	.27	.15	.28	.18	.27	.27	.23	.16	.20	.14
MCD1602	.19	.15	.19	.15	.17	.14	.19	.15	.18	.15	.18	.15	.18	.19	.19	.15	.18	.14
MC1604	.33	.23	.44	.24	.24	.18	.44	.23	.44	.20	.38	.24	.38	.44	.33	.26	.26	.19
MCD1604	.23	.17	.26	.21	.22	.16	.26	.21	.26	.19	.25	.21	.21	.26	.23	.24	.22	.16
MC1703	.25	.20	.30	.20	.20	.17	.30	.20	.30	.19	.28	.20	.28	.30	.25	.18	.21	.17
MCD1703	.20	.17	.20	.17	.19	.15	.21	.17	.19	.17	.20	.17	.19	.20	.20	.16	.19	.16

## MC DIMENSIONS

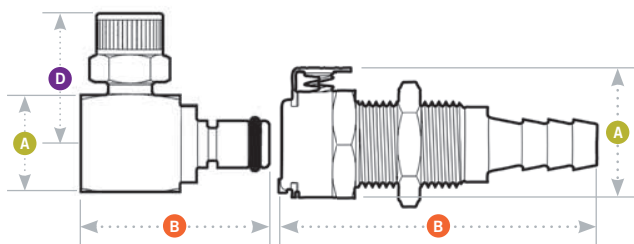

- A** = Height/Diameter
- B** = Total Length
- D** = Elbow Radial Length

### Panel Dimensions

	PANEL OPENING	PANEL THICKNESS MAX.-MIN.	PANEL NUT HEX	PANEL NUT THREAD
<b>COUPLING BODIES</b> (except male thread)	see drawing	.50 – .05	5/8	1/2-24UNS
<b>MALE THREAD</b>	see drawing	.21 – .06	5/8	1/2-24UNS
<b>COUPLING INSERTS</b>	see drawing	.30 – .06	5/8	1/2-24UNS

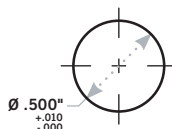

### Coupling Bodies • CHROME-PLATED BRASS



**TERMINATION**  
**IN-LINE**  
**PIPE THREAD**



**PANEL MOUNT**  
**FERRULELESS**  
**POLYTUBE FITTING,**  
**PTF†**



**PANEL MOUNT**  
**HOSE BARB**



**PANEL MOUNT**  
**FEMALE THREAD**



**PANEL MOUNT**  
**MALE THREAD**



**IN-LINE**  
**FERRULELESS**  
**POLYTUBE FITTING,**  
**PTF†**



**IN-LINE**  
**HOSE BARB**

TUBING/THREAD SIZE	METRIC EQ.	STRAIGHT THRU	SHUTOFF	<b>A</b>	<b>B</b>
1/8" NPT		MC1002	MCD1002	.76	1.00
1/8" BSPT		MC1002BSPT	MCD1002BSPT	.76	1.00
1/4" NPT		MC1004	MCD1004	.76	1.10
1/4" BSPT		MC1004BSPT	MCD1004BSPT	.76	1.10
5/32" OD, .10" ID	4.0mm OD, 2.5mm ID	MC12025	MCD12025	.76	1.67
1/4" OD, .17" ID	6.4mm OD, 4.3mm ID	MC1204	MCD1204	.76	1.77
1/8" ID	3.2mm ID	MC1602	MCD1602	.76	1.67
3/16" ID	4.8mm ID	MC1603	MCD1603	.76	1.89
1/4" ID	6.4mm ID	MC1604	MCD1604	.76	1.89
10-32 UNF		MC181032	MCD181032	.76	1.22
1/8" NPT		MC1502	MCD1502	.76	1.20
1/4" OD, .17" ID	6.4mm OD, 4.3mm ID	MC1304	MCD1304	.76	1.77
1/8" ID	3.2mm ID	MC1702	MCD1702	.76	1.67
3/16" ID	4.8mm ID	MC1703	MCD1703	.76	1.89
1/4" ID	6.4mm ID	MC1704	MCD1704	.76	1.89

All measurements are in inches (millimeters) unless otherwise noted. Tubing must meet stated inside and outside diameters.  
†NOTE: CPC's Ferruleless PTF (polytube fitting) terminations do not require ferrules to achieve a secure connection and are therefore easier to use and reuse. PTF fittings are designed for semi-rigid tubing, i.e., polyethylene, nylon, polyurethane, etc.  
NOTE: Elbow configurations are available. Contact CPC for more information.

## Coupling Inserts • CHROME-PLATED BRASS



**TERMINATION**  
**IN-LINE**  
**PIPE THREAD**  
(non-valved shown)



**IN-LINE**  
**PIPE THREAD**  
**(FEMALE)**



**PANEL MOUNT**  
**FERRULELESS**  
**POLYTUBE FITTING,**  
**PTF†**



**PANEL MOUNT**  
**HOSE BARB**



**IN-LINE**  
**FERRULELESS**  
**POLYTUBE FITTING,**  
**PTF†**



**IN-LINE**  
**HOSE BARB**



**IN-LINE**  
**FEMALE THREAD**



**ELBOW**  
**FERRULELESS**  
**POLYTUBE FITTING,**  
**PTF†**



**ELBOW**  
**HOSE BARB**

TUBING/THREAD SIZE		METRIC EQ.	STRAIGHT THRU	SHUTOFF	A	B	D
1/8" NPT			MC2402	MCD2402	.58	1.03/1.43	
1/8" BSPT			MC2402BSPT	MCD2402BSPT	.58/.72	1.03/1.43	
1/4" NPT			MC2404	MCD2404	.65	1.08/1.43	
-----							
1/8" NPT Female			MC2602	MCD2602	.58	.95/1.65	
1/4" NPT Female			MC2604	MCD2604	.72	1.15/1.82	
1/4" BSPP Female			MC2604BSPP	MCD2604BSPP	.72	1.23/1.91	
-----							
1/4" OD, .17" ID	6.4mm OD, 4.3mm ID		MC4004	MCD4004	.72	1.75/1.85	
-----							
1/8" ID	3.2mm ID		MC4202	MCD4202	.72	1.65/1.75	
3/16" ID	4.8mm ID		MC4203	MCD4203	.72	1.87/1.97	
1/4" ID	6.4mm ID		MC4204	MCD4204	.72	1.87/1.97	
-----							
5/32" OD, .10" ID	4.0mm OD, 2.5mm ID		MC20025	MCD20025	.58	1.13/1.53	
1/4" OD, .17" ID	6.4mm OD, 4.3mm ID		MC2004	MCD2004	.58	1.15/1.55	
3/8" OD, .25" ID	9.5mm OD, 6.4mm ID		MC2006	MCD2006	.58	1.30/1.50	
-----							
1/8" ID	3.2mm ID		MC2202	MCD2202	.58	1.05/1.65	
3/16" ID	4.8mm ID		MC2203	MCD2203	.58	1.25/1.85	
1/4" ID	6.4mm ID		MC2204	MCD2204	.58	1.25/1.67	
-----							
10-32 UNF			MC281032	MCD281032	.58	.63/1.30	
-----							
5/32" OD, .10" ID	4.0mm OD, 2.5mm ID		MC21025	MCD21025	.63	1.18/1.28	.81
1/4" OD, .17" ID	6.4mm OD, 4.3mm ID		MC2104	MCD2104	.63	1.18/1.28	.83
-----							
1/8" ID	3.2mm ID		MC2302	MCD2302	.62	1.18/1.28	.76
1/4" ID	6.4mm ID		MC2304	MCD2304	.63	1.18/1.28	.76

All measurements are in inches (millimeters) unless otherwise noted. Tubing must meet stated inside and outside diameters. Couplings are pictured with valves unless otherwise noted.

†Note: CPC's Ferruleless PTF (polytube fitting) terminations do not require ferrules to achieve a secure connection and are therefore easier to use and reuse. PTF fittings are designed for semi-rigid tubing, i.e., polyethylene, nylon, polyurethane, etc. NOTE: Elbow configurations are available. Contact CPC for more information.

# LIONOIL

ANTWERP LION OIL WORKS N.V.

Vlaamsekaai 2-5 B-2000 Antwerpen  
T.: +32 (0)3 237 00 45 F.: +32 (0)3 216 21 92  
info@lionoil.be www.lionoil.be

Smart fluid handling to take you forward, faster. 37